

# S-5!<sup>®</sup>

The Right Way!

These instructions are for use by those experienced in the craft. Always follow appropriate safety precautions and use appropriate tools.

## Installation Instructions

**S-5!<sup>®</sup> Warning!** Please use these products responsibly! Visit our website or contact your S-5! distributor for available load test results. The user and/or installer of these parts is responsible for all necessary engineering and design to ensure the S-5-K or S-5-R has been properly spaced and configured.

**Notice to S-5! users:** Due to the many variables involved with specific panel products, climates, snow melt phenomena and job particulars, the manufacturer cannot and does not express any opinions as to the suitability of any S-5! assembly for any specific application and assumes no liability with respect thereto. S-5! products are tested for ultimate holding strength on various profile types and materials. This information is available from the S-5! website: [www.S-5.com](http://www.S-5.com). This document is an installation guide only and the photographs and drawings herein are for the purpose of illustrating installation tools and techniques, not system designs.

**The S-5-K and S-5-R clamps are designed to fit Klip Rib and batten seam profiles.**

## Tools Needed

- Hand Ratchet / Electric Tool (13mm)
- Locking C-clamp

## To Install S-5-K or S-5-R:

- 1) Mate the clamp halves and start the M8 bolts. Thread bolt until bolt end is just flush with the outside surface of the straight (unflanged) side.
- 2) Place clamp assembly over the seam and force down until clamp snaps over seam.
- 3) Position clamp appropriately on seam, then close clamp using a locking C-clamp. Using a hand ratchet or electric tool (13mm), tighten M8 bolts by alternating back and forth between bolts until clamp is closed completely.
- 4) Remove locking C-clamp. Consult the S-5! website at [www.S-5.com](http://www.S-5.com) for published data regarding holding strength.

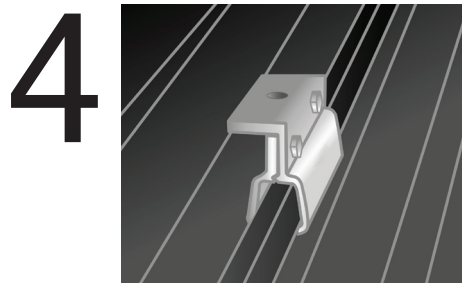
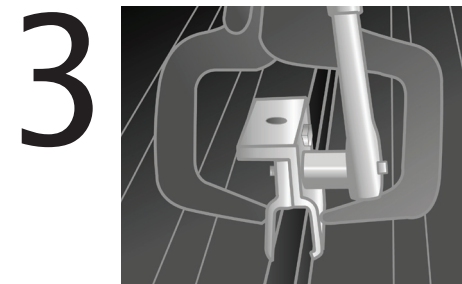
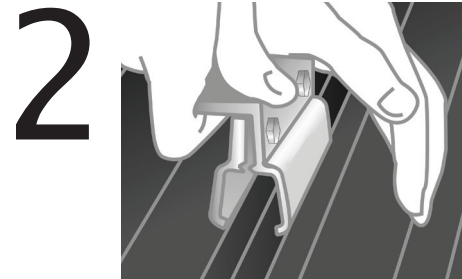
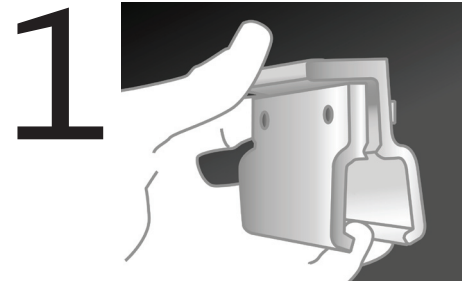

**S-5!<sup>®</sup> Warning! Please use this product responsibly!**

Products are protected by multiple U.S. and foreign patents. For published data regarding holding strength, bolt torque, patents and trademarks visit the S-5! website at [www.S-5.com](http://www.S-5.com). Copyright 2012, Metal Roof Innovations, Ltd. S-5! products are patent protected. S-5! aggressively protects its patents, trademarks and copyrights.

The right way to attach almost anything to metal roofs!

888-825-3432

[www.S-5.com](http://www.S-5.com)

# S-5!<sup>®</sup>

The Right Way!

## Installation Instructions

The S-5!<sup>®</sup> Mini clamps are made for a variety of standing seam profiles. When attaching S-5! mini clamps are cost effective, non-penetrating standing seam clamps designed for medium-duty applications. They are a bit shorter than the standard clamps, having one M8 Bolt rather than two.

The S-5-K Mini, S-5-R Mini, and S-5-K700 are designed to fit Klip Rib, Rib Roof, Lysaght Klip-Lok 700 Hi-Strength<sup>®</sup>, and similar seam profiles (see clamp profiles below).

### To Install S-5-K Mini, S-5-R Mini or S-5-K700:

- 1) Mate the clamp halves and start the M8 bolt. Thread bolt until bolt end is just flush with the outside surface of the opposite side of the clamp.
- 2) Place clamp assembly over the seam and force down until clamp snaps over seam.
- 3) Position clamp appropriately on seam, then close clamp using a locking C-clamp. Using a hand ratchet or electric tool (13mm), tighten M8 bolt until clamp is closed completely.
- 4) Remove locking C-clamp. Consult the S-5! website at [www.S-5.com](http://www.S-5.com) for published data regarding holding strength.

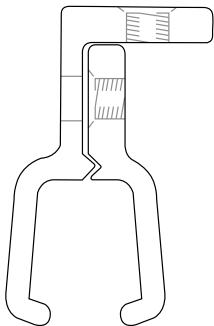

S-5-K Mini



S-5-R Mini

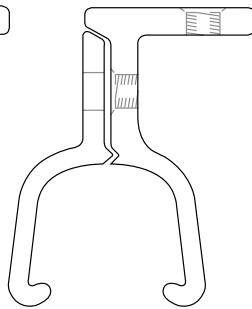

S-5-K700

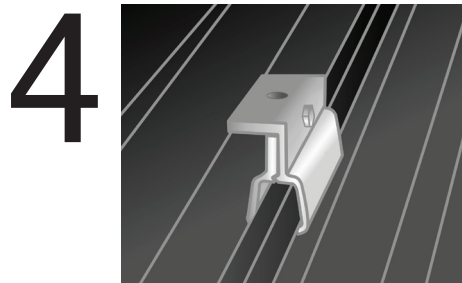
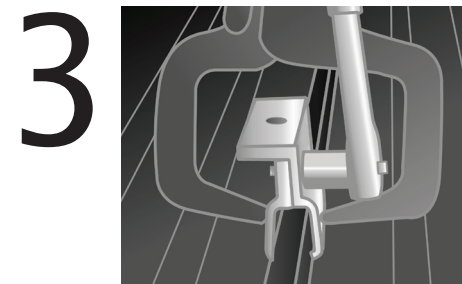
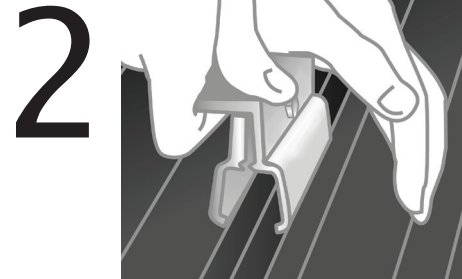
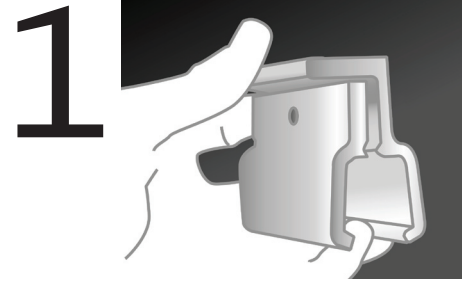

#### S-5!<sup>®</sup> Warning! Please use this product responsibly!

Products are protected by multiple U.S. and foreign patents. For published data regarding holding strength, bolt torque, patents and trademarks visit the S-5! website at [www.S-5.com](http://www.S-5.com). Copyright 2012, Metal Roof Innovations, Ltd. S-5! products are patent protected. S-5! aggressively protects its patents, trademarks and copyrights.

The right way to attach almost anything to metal roofs!

888-825-3432

[www.S-5.com](http://www.S-5.com)

S-5-K Mini, S-5-R Mini and S-5-K700 Install